

George Daniell

to

Wm. D. W. Peck.

(R. St. 50 cts)

The State of Texas |

Gonzales County |

Know all men by these presents, that I, George Daniell of the County of Caldwell and State aforesaid for and in consideration of the sum of Four hundred and twenty five Dollars to me in hand paid by W. D. W Peck surviving partner of the late firm of B. B. Peck & Co. the receipt whereof is hereby acknowledged, have granted, bargained and sold and by these presents do grant bargain sell and convey to said W. D. W. Peck survivor & c. the following described piece or parcel of land, situate in Kimball County, Texas, but more particularly described as follows:

*in 1868
on Peck's
land
purchased
in Texas*

Situated in the Bexar District, known as Survey No. 60 in Section No. 7 on the South side of the North fork of the Llano River: Beginning at a Stake on the bank of the River the N. E. corner of Survey No. 59 from which an Elm bears N. 82° E. 4 varas, another bears S. 81° W. 4 varas. ~~another~~ Thence South with the East boundary of Survey No. 59, thirty eight hundred varas to a stake and mound. Thence East at nine hundred and fifty varas a stake & mound. Thence North at thirty four hundred and sixty varas a stake on the bank of the river, from which a Live oak bears S. 82° E. 21 varas an Elm bears N. 3° E. 6 varas. Thence up the river with its meanders to the place of Beginning, Bearings marked X. Containing six hundred and forty acres, it being the same tract granted by the Government by Patent No. 64 to George Daniell. To have and to hold said tract of land unto the said W. D. W. Peck, his heirs and assigns forever.

*11/17/68
is the same
as Patent
Hlo 4
did
rec
no
the one
patent?*

And I do hereby covenant and agree that I will forever warrant and defend the title to said land unto the said W. D. W. Peck, his heirs and assigns forever against the claim or claims of all persons claiming the same or any part thereof.

Given under my hand this 30th. day of November A. D. 1868.

Witness:

sig Joseph O'Conner
Jas. F. Mathew.

sig. George Daniell.

The State of Texas |

Gonzales County |

Before me F Chenault Clerk of the County Court of said County, personally appeared George Daniel, whose name is signed to the foregoing Instrument of writing, well known to me, and acknowledged, that he executed the same appended hereto for the consideration & purposes therein set forth.

To which I certify under my hand and official seal this 30th. day of November 1868.

(L. S.)

sig. F Chenault.

Clk C. C. G. C.

Filed for record January the 5th. 1869 at 8 o'clock A M. and recorded January the 7th. 1869 at 7 o'clock P. M. in Book J pages 316 & 317.

H Ochs, Clk.

3070
1868

George Daniell

to

Wm. D. W. Peck.

(R. St. 50 cts)

The State of Texas |

Gonzales County | Know all men by these presents, that I, George Daniell of the County of Caldwell and State aforesaid for and in consideration of the sum of Four hundred and twenty five Dollars to me in hand paid by W. D. W Peck surviving partner of the late firm of B. B. Peck & Co. the receipt whereof is hereby acknowledged, have granted, bargained and sold and by these presents do grant bargain sell and convey to said W. D. W. Peck survivor & c. the following described piece or parcel of land, situate in Kimball County, Texas, but more particularly described as follows:

Situated in the Bexar District, known as Survey No. 60 in Section No. 7 on the South side of the North fork of the Llano River: Beginning at a Stake on the bank of the River the N. E. corner of Survey No. 59 from which an Elm bears N. 82° E. 4 varas, another bears S. 81° W. 4 varas. ~~another~~ Thence South with the East boundary of Survey No. 59, thirty eight hundred varas to a stake and mound. Thence East at nine hundred and fifty varas a stake & mound. Thence North at thirty four hundred and sixty varas a stake on the bank of the river, from which a Live oak bears S. 82° E. 21 varas an Elm bears N. 3° E. 6 varas. Thence up the river with its meanders to the place of Beginning, Bearings marked X. Containing six hundred and forty acres, it being the same tract granted by the Government by Patent No. 64 to George Daniell. To have and to hold said tract of land unto the said W. D. W. Peck, his heirs and assigns forever.

And I do hereby covenant and agree that I will forever warrant and defend the title to said land unto the said W. D. W. Peck, his heirs and assigns forever against the claim or claims of all persons claiming the same or any part thereof.

Given under my hand this 30th. day of November A. D. 1868.

Witness:

sig Joseph O'Conner - *Admr. of Levi Daniel Probate 1876* sig. George Daniell.
Jas. F. Mathew.

The State of Texas |

Gonzales County | Before me F Chenault Clerk of the County Court of said County, personally appeared George Daniel, whose name is signed to the foregoing Instrument of writing, well known to me, and acknowledged, that he executed the same appended hereto for the consideration & purposes therein set forth.

To which I certify under my hand and official seal this 30th. day
(L. S.) of November 1868.

sig. F Chenault.
Clk C. C. G. C.

Filed for record January the 5th. 1869 at 8 o'clock A M. and recorded January the 7th. 1869 at 7 o'clock P. M. in Book J pages 316 & 317.

H Cchs, Clk.

This was filed in Gillespie County, Tx.

Field notes of a survey of six hundred and forty acres of land made for George Daniel it being the quantity of land to which he is entitled by virtue of certificate No 20 issued by the Board of Commissioners for Gonzales Co calling for six hundred and forty acres of land.

Said survey is No. 60 in section No. 7

Situated on the South side of the North Fork of the Llano River about 3 miles above its junction with the South Fork.

Beginning at stake set on the bank of the river for N.E. corner of survey No. 59 and then to W corner of this survey from which an elm 14 inches in dia bears N 82 E 400 another 12 inches in dia bears S 81 W 400.

Thence South with the East boundary line of said survey 3800 varas to a stake and mound for the S.W. corner of this survey.

Thence East 950 varas to a stake and mound for the S.E. corner of this survey.

Thence North 3460 varas to a stake set on the bank of the river for the N.E. corner of this survey from which a Live oak 11 inches in dia bears S 82 E 510 an elm 8 inches in dia bears N 3 E 600

Thence up the river with its meanders to the place of beginning. Bearing trees marked thus X

Lewis Mallett } Chain
Antonio Coy } Carriers

I, Ben McCulloch, do solemnly declare under the oath of my office that the foregoing survey was made since the first day of August last, and according to law.

Surveyed Oct 31 1841

Ben McCulloch

Deft Surveyor, Bexar County

I, John James, District Surveyor Bexar do hereby certify that I have examined the foregoing plat and field notes and find them to be correct, and that they are recorded in my office in Book A No 4 page 390

San Antonio }
March 17th 1848 }
X

John James
Dist. Surveyor, Bexar Dist.

G Daniel
658

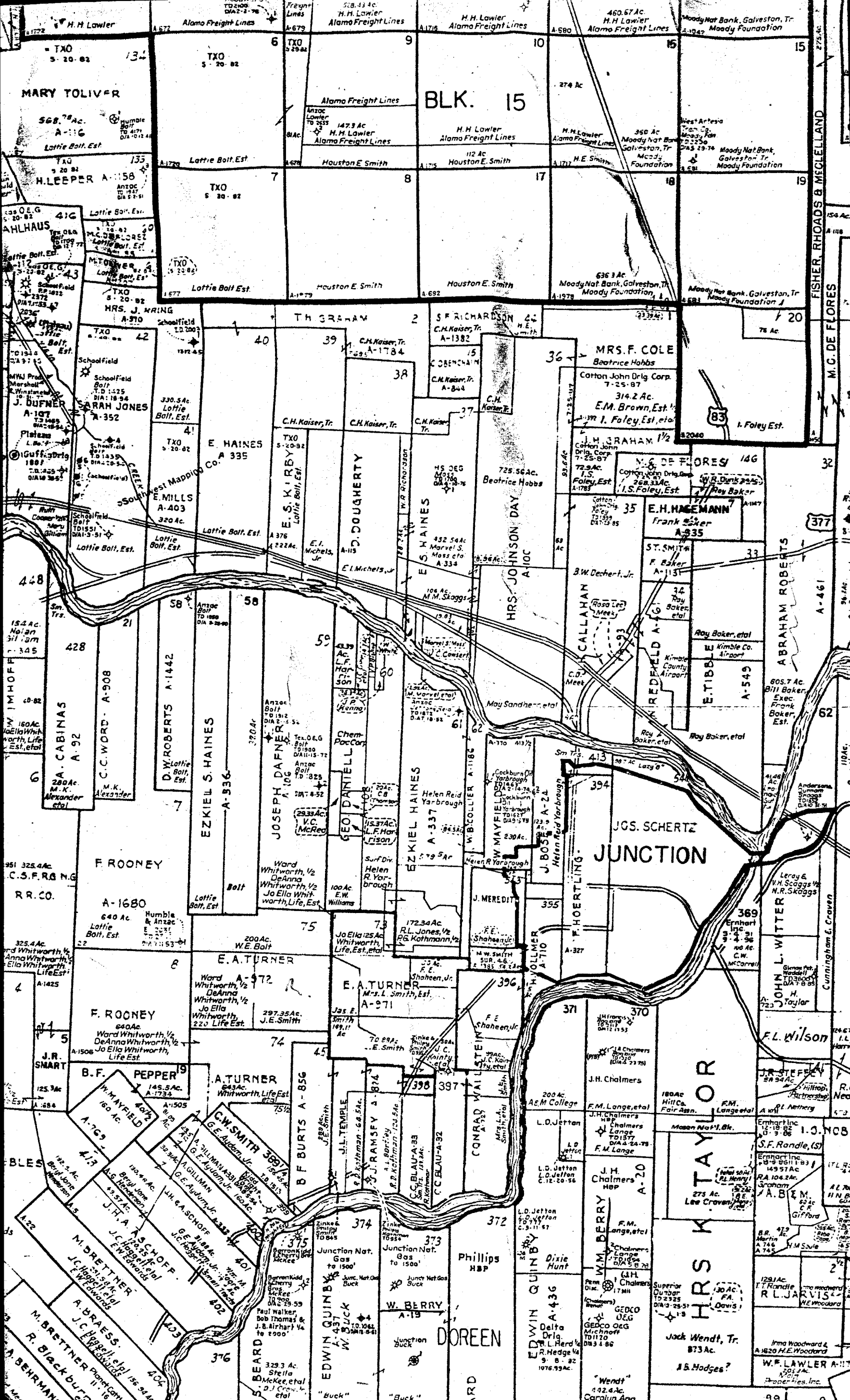

MARY TOLIVER
568.78 Ac.
Lottie Bolt, Est.

BLK. 15

H. H. LAWLER
TXO 5-20-82
Lottie Bolt, Est.

H. H. LAWLER
TXO 5-20-82
Lottie Bolt, Est.

J. DUFNER
A-107
Lottie Bolt, Est.

A. CABINAS
A-92
Lottie Bolt, Est.

F. ROONEY
A-1680
Lottie Bolt, Est.

F. ROONEY
A-1506
Lottie Bolt, Est.

B. F. PEPPER
A-1734
Lottie Bolt, Est.

M. DRETTNER
A-1734
Lottie Bolt, Est.

M. BRETNER
A-1734
Lottie Bolt, Est.

Alamo Freight Lines
TXO 5-20-82
Lottie Bolt, Est.

H. H. LAWLER
TXO 5-20-82
Lottie Bolt, Est.

H. H. LAWLER
TXO 5-20-82
Lottie Bolt, Est.

E. HAINES
A-335
Lottie Bolt, Est.

E. S. KIRBY
A-376
Lottie Bolt, Est.

E. A. TURNER
A-972
Lottie Bolt, Est.

E. A. TURNER
A-971
Lottie Bolt, Est.

A. TURNER
A-856
Lottie Bolt, Est.

C. W. SMITH
A-856
Lottie Bolt, Est.

EDWIN GUNBY
A-437
Lottie Bolt, Est.

Alamo Freight Lines
TXO 5-20-82
Lottie Bolt, Est.

H. H. LAWLER
TXO 5-20-82
Lottie Bolt, Est.

H. H. LAWLER
TXO 5-20-82
Lottie Bolt, Est.

C. H. KAISER, Tr.
A-1784
Lottie Bolt, Est.

C. H. KAISER, Tr.
A-1115
Lottie Bolt, Est.

JOSEPH DAFNER
A-106
Lottie Bolt, Est.

E. A. TURNER
A-971
Lottie Bolt, Est.

A. TURNER
A-856
Lottie Bolt, Est.

C. W. SMITH
A-856
Lottie Bolt, Est.

EDWIN GUNBY
A-437
Lottie Bolt, Est.

Alamo Freight Lines
TXO 5-20-82
Lottie Bolt, Est.

H. H. LAWLER
TXO 5-20-82
Lottie Bolt, Est.

H. H. LAWLER
TXO 5-20-82
Lottie Bolt, Est.

C. H. KAISER, Tr.
A-1382
Lottie Bolt, Est.

C. H. KAISER, Tr.
A-804
Lottie Bolt, Est.

JOSEPH DAFNER
A-106
Lottie Bolt, Est.

E. A. TURNER
A-971
Lottie Bolt, Est.

A. TURNER
A-856
Lottie Bolt, Est.

C. W. SMITH
A-856
Lottie Bolt, Est.

EDWIN GUNBY
A-437
Lottie Bolt, Est.

Alamo Freight Lines
TXO 5-20-82
Lottie Bolt, Est.

H. H. LAWLER
TXO 5-20-82
Lottie Bolt, Est.

H. H. LAWLER
TXO 5-20-82
Lottie Bolt, Est.

C. H. KAISER, Tr.
A-1382
Lottie Bolt, Est.

C. H. KAISER, Tr.
A-804
Lottie Bolt, Est.

JOSEPH DAFNER
A-106
Lottie Bolt, Est.

E. A. TURNER
A-971
Lottie Bolt, Est.

A. TURNER
A-856
Lottie Bolt, Est.

C. W. SMITH
A-856
Lottie Bolt, Est.

EDWIN GUNBY
A-437
Lottie Bolt, Est.

Alamo Freight Lines
TXO 5-20-82
Lottie Bolt, Est.

H. H. LAWLER
TXO 5-20-82
Lottie Bolt, Est.

H. H. LAWLER
TXO 5-20-82
Lottie Bolt, Est.

C. H. KAISER, Tr.
A-1382
Lottie Bolt, Est.

C. H. KAISER, Tr.
A-804
Lottie Bolt, Est.

JOSEPH DAFNER
A-106
Lottie Bolt, Est.

E. A. TURNER
A-971
Lottie Bolt, Est.

A. TURNER
A-856
Lottie Bolt, Est.

C. W. SMITH
A-856
Lottie Bolt, Est.

EDWIN GUNBY
A-437
Lottie Bolt, Est.

Alamo Freight Lines
TXO 5-20-82
Lottie Bolt, Est.

H. H. LAWLER
TXO 5-20-82
Lottie Bolt, Est.

H. H. LAWLER
TXO 5-20-82
Lottie Bolt, Est.

C. H. KAISER, Tr.
A-1382
Lottie Bolt, Est.

C. H. KAISER, Tr.
A-804
Lottie Bolt, Est.

JOSEPH DAFNER
A-106
Lottie Bolt, Est.

E. A. TURNER
A-971
Lottie Bolt, Est.

A. TURNER
A-856
Lottie Bolt, Est.

C. W. SMITH
A-856
Lottie Bolt, Est.

EDWIN GUNBY
A-437
Lottie Bolt, Est.